

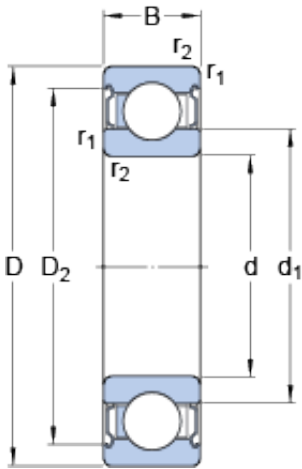

GBMA Bearing Manufacturing Co.,Ltd



6220-2Z/VA228 Bearing 2D drawings and 3D CAD models

6220-2Z/VA228 SKF High Temperature Insert Bearings

Bearing No. 6220-2Z/VA228

| | |
|---|--------------------------|
| Size | 180x100x34 mm |
| Bore Diameter | 180 mm |
| Outer Diameter | 100 mm |
| Width | 34 mm |
| d | 100 mm |
| D | 180 mm |
| B | 34 mm |
| d ₁ | 124.8 mm |
| D ₂ | 159.9 mm |
| r _{1,2} - min. | 2.1 mm |
| d _a - min. | 112 mm |
| d _a - max. | 124 mm |
| D _a - max. | 168 mm |
| r _a - max. | 2 mm |
| Basic dynamic load rating - C | 127 kN |
| Basic static load rating - C ₀ | 93 kN |
| Limiting speed | 60 r/min |
| Limiting temperature - T | 350 ° C |
| Category | Single Row Ball Bearings |
| Inventory | 0.0 |
| Manufacturer Name | SKF |
| Minimum Buy Quantity | N/A |
| Weight / Kilogram | 3.316 |
| Product Group | B00308 |
| | |



GBMA Bearing Manufacturing Co.,Ltd

| | |
|---------------------------------|--|
| Enclosure | 2 Metal Shields |
| Precision Class | ABEC 1 ISO P0 |
| Maximum Capacity / Filling Slot | No |
| Rolling Element | Ball Bearing |
| Snap Ring | No |
| Internal Special Features | Coronet Cage |
| Cage Material | Graphite |
| Internal Clearance | C0-Medium |
| Inch - Metric | Metric |
| Long Description | 100MM Bore; 180MM Outside Diameter; 34MM Outer Race Width; 2 Metal Shields; Ball Bearing; ABEC 1 ISO P0; No Filling Slot; No Snap Ring; Coronet Cage Internal Special Features; C0-Medium Internal Cle |
| Other Features | Deep Groove Extreme Temperature Variant |
| Category | Single Row Ball Bearing |
| UNSPSC | 31171504 |
| Harmonized Tariff Code | 8482.10.50.68 |
| Noun | Bearing |
| Keyword String | Ball |
| Manufacturer URL | http://www.skf.com |
| Weight / LBS | 3.15 |
| Outer Race Width | 1.339 Inch 34 Millimeter |
| Inner Race Width | 0 Inch 0 Millimeter |
| Bore | 3.937 Inch 100 Millimeter |
| Outside Diameter | 7.087 Inch 180 Millimeter |
| d ₁ | 124.8 mm |
| D ₂ | 159.9 mm |
| r _{1,2} min. | 2.1 mm |
| | |



GBMA Bearing Manufacturing Co.,Ltd

| | |
|--------------------------------|---------|
| d_a min. | 112 mm |
| d_a max. | 124 mm |
| D_a max. | 168 mm |
| r_a max. | 2 mm |
| Basic dynamic load rating C | 127 kN |
| Basic static load rating C_0 | 93 kN |
| Limiting temperature T max. | 350 ° C |
| Mass bearing | 3.27 kg |