

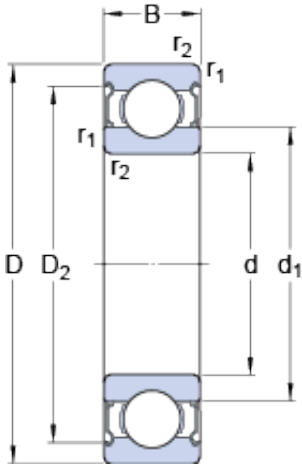

# GBMA Bearing Manufacturing Co.,Ltd



6213-2Z/VA201 Bearing 2D drawings and 3D CAD models

## 6213-2Z/VA201 SKF High Temperature Insert Bearings

Bearing No. 6213-2Z/VA201

Size	120x65x23 mm
Bore Diameter	120 mm
Outer Diameter	65 mm
Width	23 mm
d	65 mm
D	120 mm
B	23 mm
d <sub>1</sub>	83.3 mm
D <sub>2</sub>	105.8 mm
r <sub>1,2</sub> - min.	1.5 mm
d <sub>a</sub> - min.	74 mm
d <sub>a</sub> - max.	83.2 mm
D <sub>a</sub> - max.	111 mm
r <sub>a</sub> - max.	1.5 mm
Basic dynamic load rating - C	58.5 kN
Basic static load rating - C <sub>0</sub>	40.5 kN
Limiting speed	40 r/min
Limiting temperature - T	250 ° C
Category	Single Row Ball Bearings
Inventory	0.0
Manufacturer Name	SKF
Minimum Buy Quantity	N/A
Weight / Kilogram	0
Product Group	B00308



## GBMA Bearing Manufacturing Co.,Ltd

Enclosure	2 Metal Shields
Precision Class	ABEC 1   ISO P0
Maximum Capacity / Filling Slot	No
Rolling Element	Ball Bearing
Snap Ring	No
Internal Special Features	Polyalkylene Glycol/Graphite Mixture Filled
Cage Material	Steel
Internal Clearance	C0-Medium
Inch - Metric	Metric
Long Description	65MM Bore; 120MM Outside Diameter; 23MM Outer Race Width; 2 Metal Shields; Ball Bearing; ABEC 1   ISO P0; No Filling Slot; No Snap Ring; Polyalkylene Glycol/Graphite Mixture Filled Internal Special Fe
Other Features	Deep Groove   Extreme Temperature Variant
Category	Single Row Ball Bearing
UNSPSC	31171504
Harmonized Tariff Code	8482.10.50.68
Noun	Bearing
Keyword String	Ball
Manufacturer URL	<a href="http://www.skf.com">http://www.skf.com</a>
Weight / LBS	1.05
Bore	2.559 Inch   65 Millimeter
Inner Race Width	0 Inch   0 Millimeter
Outside Diameter	4.724 Inch   120 Millimeter
Outer Race Width	0.906 Inch   23 Millimeter
d <sub>1</sub>	83.3 mm
D <sub>2</sub>	105.8 mm
r <sub>1,2</sub> min.	1.5 mm



## GBMA Bearing Manufacturing Co.,Ltd

$d_a$ min.	74 mm
$d_a$ max.	83.2 mm
$D_a$ max.	111 mm
$r_a$ max.	1.5 mm
Basic dynamic load rating C	58.5 kN
Basic static load rating $C_0$	40.5 kN
Limiting temperature T max.	250 ° C
Mass bearing	1.05 kg